

HAPPY SCRAPPY CHRISTMAS TREE

Sewing instructions:

For half square triangles: Pair up the 10 background squares with the 10 tree squares right sides together. These squares will be the ones that were cut either $3\frac{3}{8}$ or $2\frac{3}{8}$ or $1\frac{7}{8}$ depending on the size that you picked.

Draw a line on diagonal. Stitch a **very scant** $\frac{1}{4}$ " from the drawn line. Cut on line. Open block and press to the dark fabric. Trim, if needed, to either 3 or 2 or 1.5 depending on your size. This will give you 20 half square triangle blocks. These blocks will be the outer "points" on your tree.

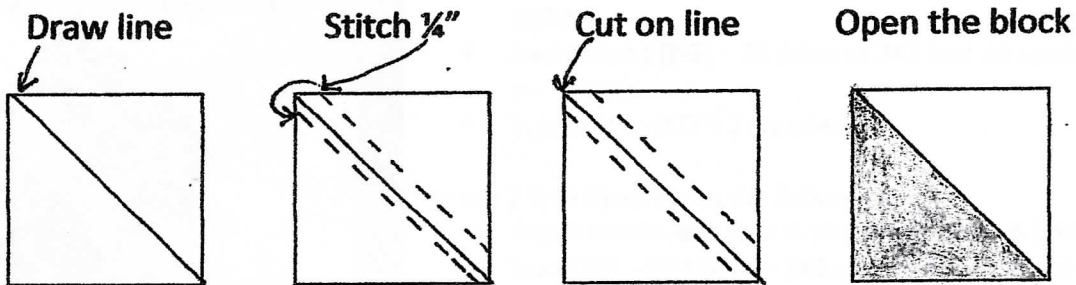

Now is the easy part 😊

Just refer to the tree design photo for the proper layout of each row. Play with your fabrics to ensure that any lights and darks get distributed throughout the wall hanging. Sew row blocks together, and then sew rows together. How easy was that!!!!

You determine your finishing details: borders, quilting, binding.

Hint: This makes wonderful Christmas gifts for your family and friends!